

www.sitecna.eu

AISI 316L glass tube flowmeter – FLGSS series

Flussimetro a tubo di vetro in AISI 316L – serie FLGSS

- Instant flowmeters for low flows
- Excellent accuracy
- Rear ports
- FKM gasket (other on demand)
- Low cost
- ATEX 2014/34/UE II 2G Ex h IIC T6/T5 Gb X
- & approved II 2D Ex h IIIC T85°C/T100°C Db X

- Flussimetro per misurazioni istantanee di basse portate
- Eccellente precisione
- Connessioni posteriori
- Guarnizioni in FKM (altre su richiesta)
- Basso costo
- ATEX 2014/34/UE II 2G Ex h IIC T6/T5 Gb X
- Approvato ed II 2D Ex h IIIC T85°C/T100°C Db X



Dimension

Dimensioni

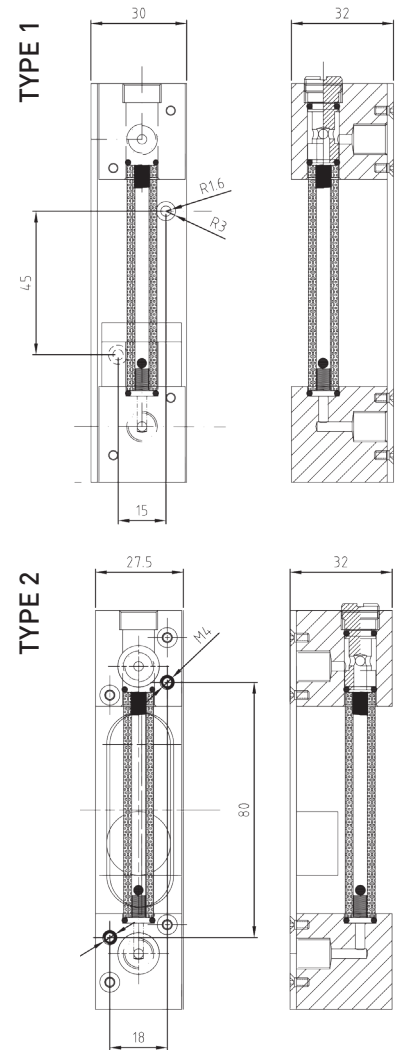

Technical datas

Informazioni tecniche

Port threads Connessioni	1/8" NPT F
Flow range Portata	0.2-2,5 NL/m air 20°C P=1013mbar 0.8-10 NL/m air 20°C P=1013mbar
Accuracy Precisione	± 5% of max scale value
Length of reading scale Lunghezza scala lettura	63 mm
Float Galleggiante	Stainless Steel
Body material Materiale corpo	AISI 316L - Aluminum bracket
Metering tube Tubo di misura	Borosilicate glass (Pyrex)
Linings - Guarnizioni	FKM (other on demand)
Max Inlet Pressure Pressione max ingresso	10 bar
Temperature range Temperatura	-20° +90°C
Options Opzioni	Stainless steel bracket

Ordering information

Come ordinare

TYPE ← **FLGSS** **H** **SE1** **-VI** → **METERING VALVE**
 FLGSS = flow meter type 1
 FLGSN = flow meter type 2
 -- = none
 VI = inlet metering valve
 VO = outlet metering valve

FLOW
 A = Flow 0.2 - 2,5 NL/m
 H = Flow 0.8 - 10 NL/m

SENSOR
 000 = No alarm included
 SE1 = monostable alarm P+F RC10-14-NO
 SE2 = monostable alarm P+F NCB5-18GM40-NO*
 *only with type2 and flow H

BT-FLSS/C20A